

PARK in a TRUCK

DREAM

W O R K B O O K



A do-it-yourself toolkit for neighborhood parks

The Landscape Architecture Program +
The Lab for Social and Urban Innovation
Thomas Jefferson University
Philadelphia, PA

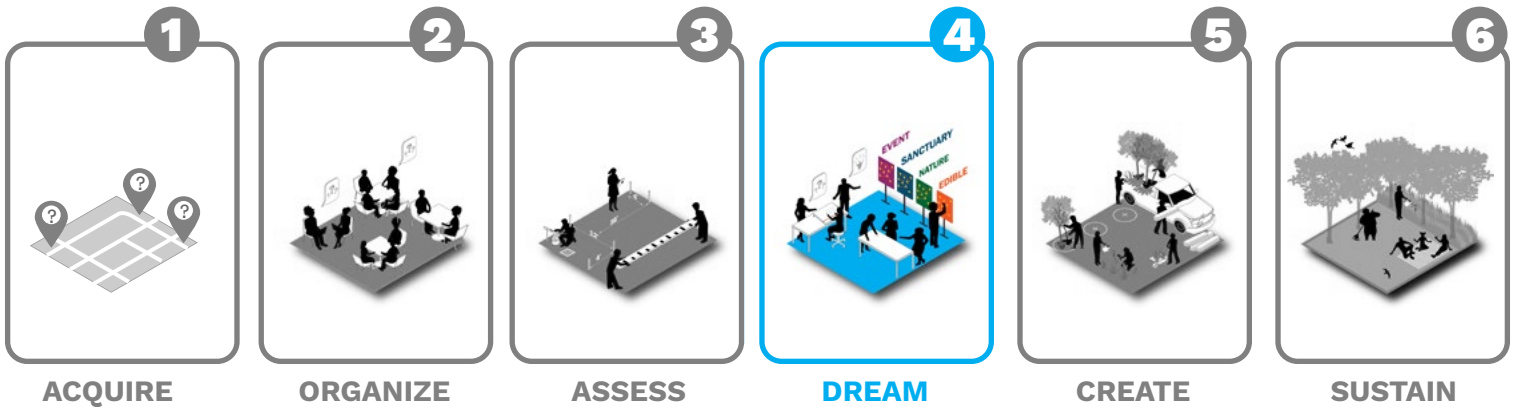

DOWNLOAD
ACQUIRE
WORKBOOK



DOWNLOAD
ORGANIZE
WORKBOOK



DOWNLOAD
ASSESS
WORKBOOK



DOWNLOAD
CREATE
WORKBOOK



DOWNLOAD
THE SUSTAIN
WORKBOOK

PARK IN A TRUCK TOOLKIT - WORKING VERSION 1.0

Kimberlee.Douglas@jefferson.edu

ParkinaTruck@jefferson.edu

This toolkit is a working toolkit, a formalized process of how a few communities have bettered themselves through designing, building and maintaining their own park. As a working toolkit, it is a work in progress. It is not perfect, but it is a great start towards a complex issue distilled into a few chapters. This is the first of several versions that will be published. Behind the scenes many parks are being build, communities bettering themselves, and people reviewing this process. Each park built, each community meeting, and every trip to home depot - something is learned. All this knowledge gained contributes to this book continuously as a feedback loop. Also crucial to the next version is getting feedback from professionals, organizations, and most importantly, community members like you! Please share your thoughts, questions, or ideas with us!

Welcome to the Dream Workbook! This book assumes you have already read the Park in a Truck Toolkit and completed Workbooks 1, 2 and 3.



DREAM CONTENTS

**THEMED PARKS + KEY
HOW TO USE THE PIECES
BASE MAP
PARK PIECES
RIGHT-SIZING YOUR PARK
ESTIMATING PARK COST
CHOOSE YOUR PLANTS**

This workbook explains how to use the park puzzle pieces to create your dream park. Work together as a team to solve this puzzle and have fun!



OVERVIEW

Designing a Park in a Truck park is like buying a new dress or suit. First, you go to the store and check out the mannequins to pick out a style, color or pattern that you like. Of course, what looks good hanging on the rack may not work for you. So, you must find the suit or dress in a size that fits you and your body type, then you try it on. If it doesn't fit, you can alter it. Finally, you add accessories to truly customize it.

Just like clothes shopping, your park needs to suit your style and the intended use. Park in a Truck parks come in four different styles. We call them Themes: EDIBLE, SANCTUARY, NATURE AND EVENT. Each one is best suited for a specific occasion or situation.

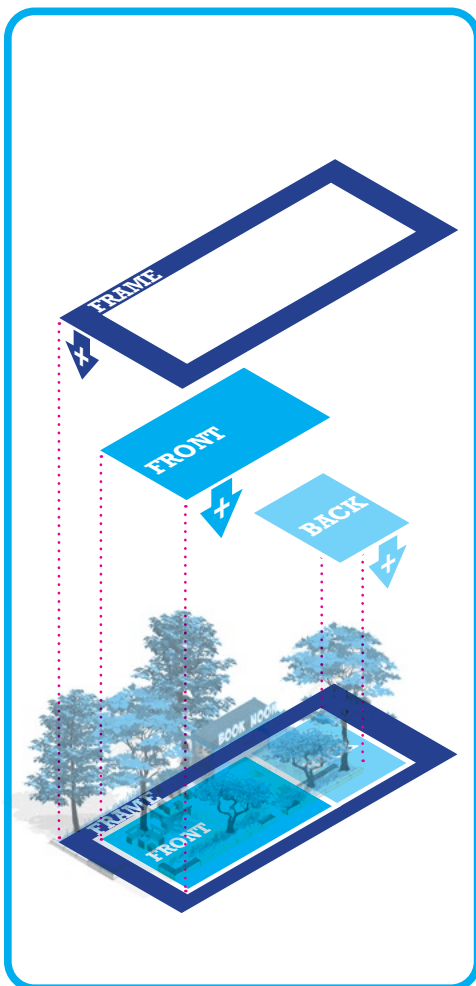

PARK PIECES

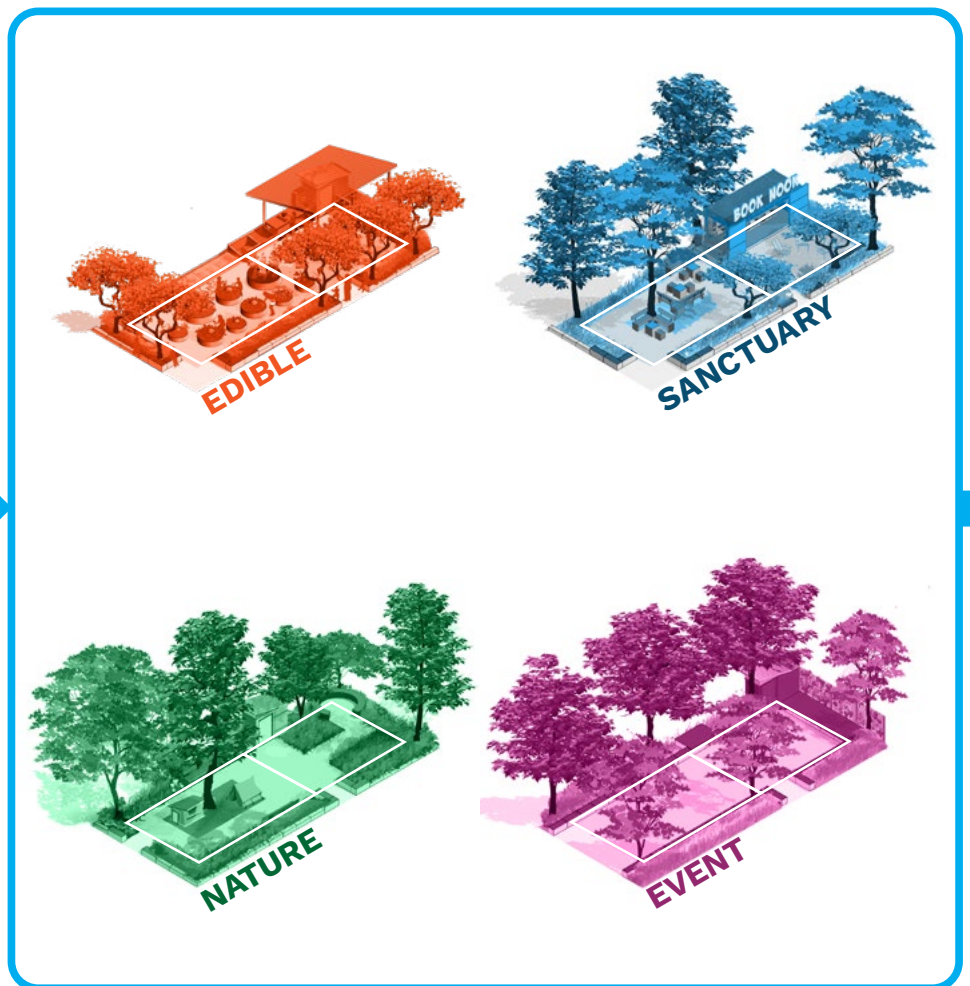

THEMED PARKS

Since every park has three parts—a FRAME, FRONT and a BACK—you can use one theme across the entire park or MIX AND MATCH different themes. This is no different than choosing a nice top and jacket to go with the bottom of your outfit.

We're all happiest when we wear clothes that we feel comfortable in. So too, you decide what park theme works best for you and your community.

This Workbook will outline the key steps:

1. Choose a theme or themes that you want featured in the park.
2. Select the components in a size that roughly fits your lot size.
3. Fine tune the park design to fit your lot size and configuration..

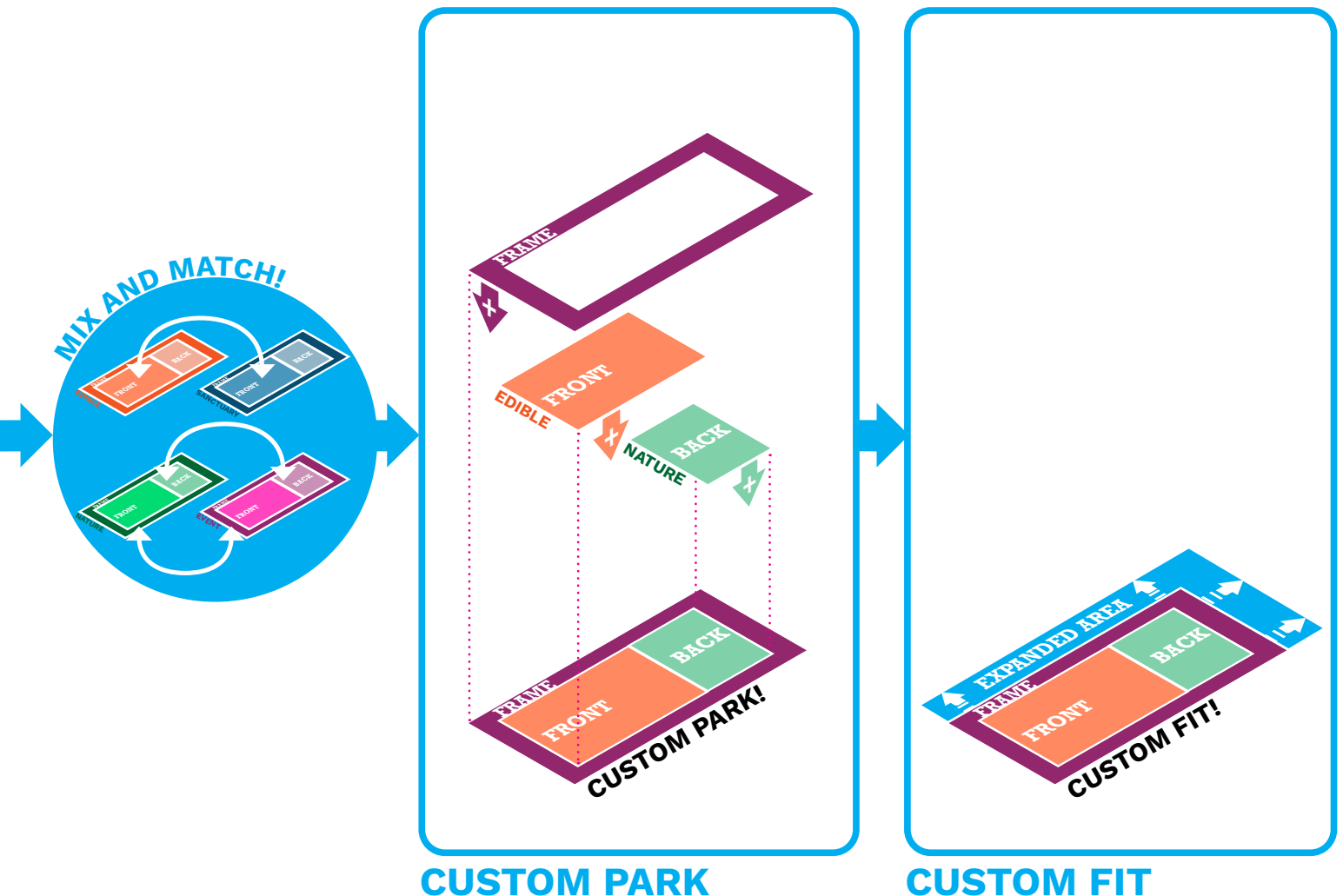



PARK PIECES

Your park design template includes different components—‘park pieces.’ There are FRONT and BACK pieces for the park inside, and a FRAME to put them in. Each of these pieces comes in one of four different themes—Edible, Sanctuary, Nature and Event.—that you will select. All pieces are interchangeable and go together like a puzzle, so you can mix and match between the different themes or choose one theme for the entire park.

You will pick a frame that is roughly the size of your lot to put the pieces in. Later, if there’s space in your park, you can add additional elements.

FRAME

Like the frame around a family photo, the park ‘frame’ creates the border around the park’s interior. This helps distinguish the park from adjacent properties and creates a welcoming location for park entrances, trees, and other features.

FRONT

The interior of the park is divided into two parts, the ‘Front’ and the ‘Back.’ The front area is the location closest to the park entrance, and holds the major fixed elements.

BACK

The other half of the park interior is the ‘Back.’ Compared to the ‘Front.’ This area is typically open to provide more flexibility of park uses.

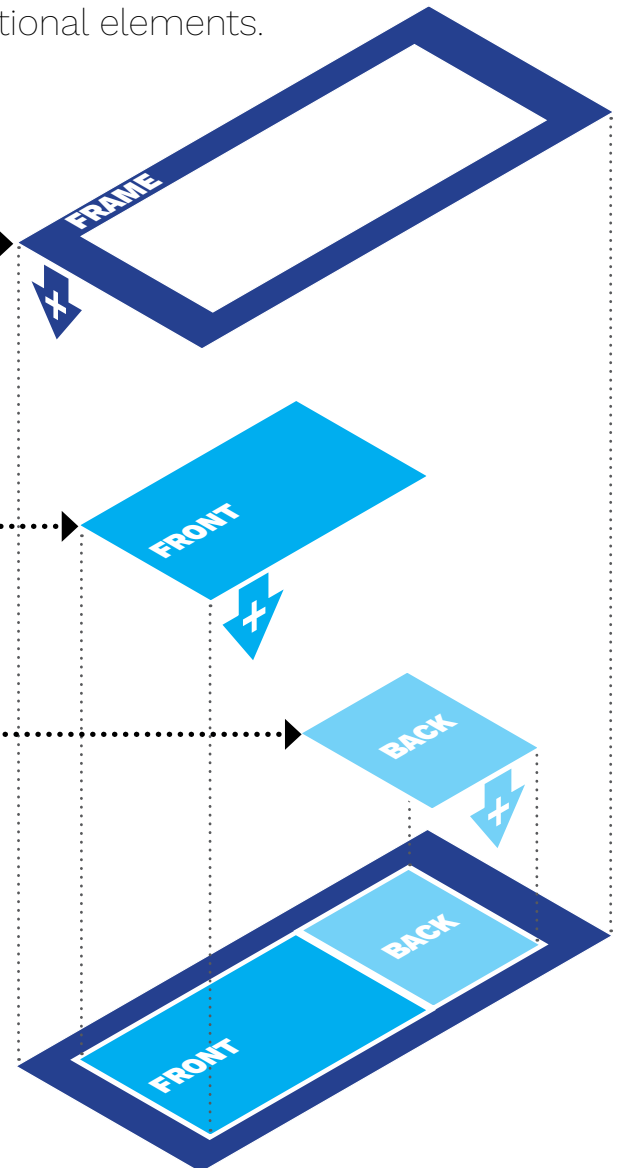

PARK AXON VIEW



PARK PIECES

In the Park in a Truck Toolkit book, and on the previous page, these pieces are shown in a 3D view, like a photograph with perspective, to make them easier to see. You will need to lay out your park using a PLAN view that looks like a simple flat map or diagram. The themed park pieces you will print out later are in the plan view, and the themed designs will show the parks in both 3D and plan views. 3D and Plan views look different, but they show the same things. Let's get acquainted with the pieces in the plan view.

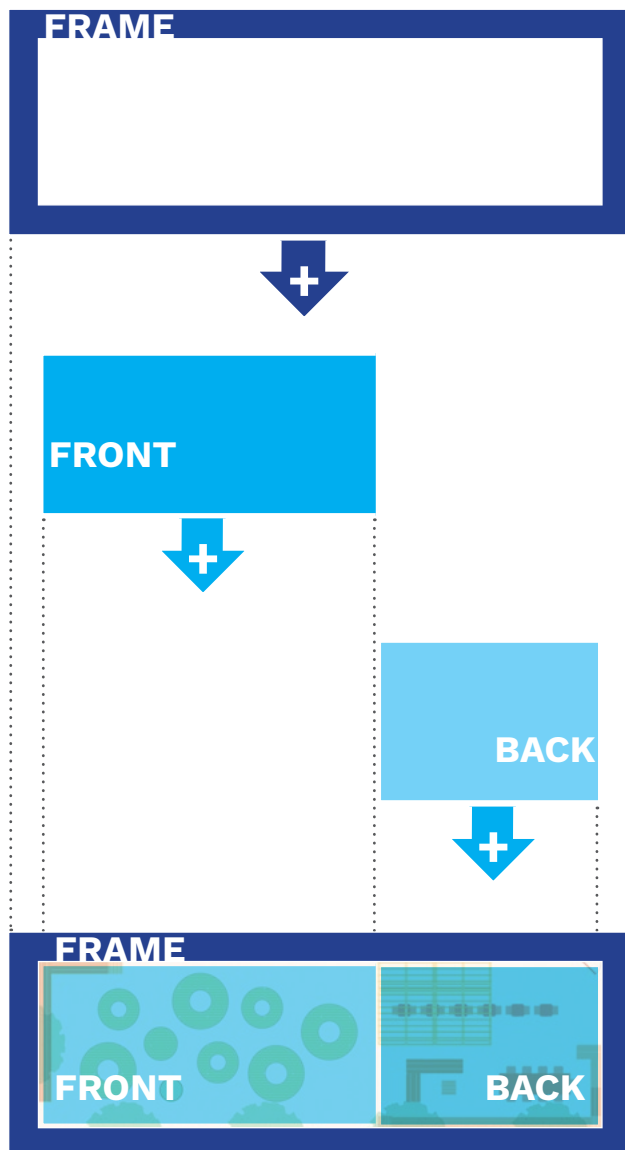

PARK PLAN VIEW



THEMED DESIGN

As stated earlier, there are four different park themes to help you identify the best type of park for your community. These themes are:

Edible | Sanctuary | Nature | Event

Each theme emphasizes different ways you may use your park. For example, some park themes are well suited for neighborhood gatherings, while others are better suited for solitude. Each theme allows for different types of uses and include different elements. The themes are illustrated below, and those individual elements are described on the next page. Use your Summary Worksheet from the Assess Workbook to ensure the theme you like is compatible with your site.

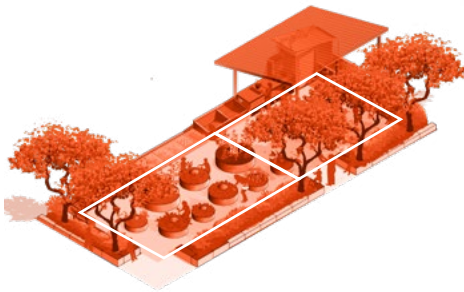

EDIBLE THEME

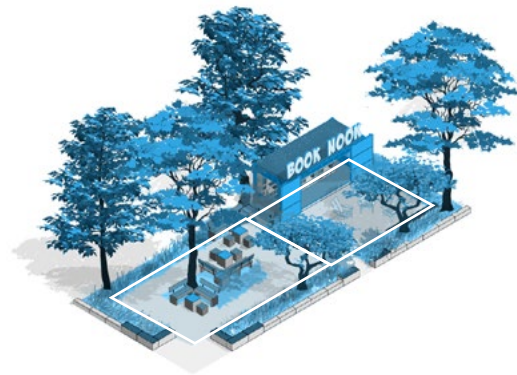

SANCTUARY THEME

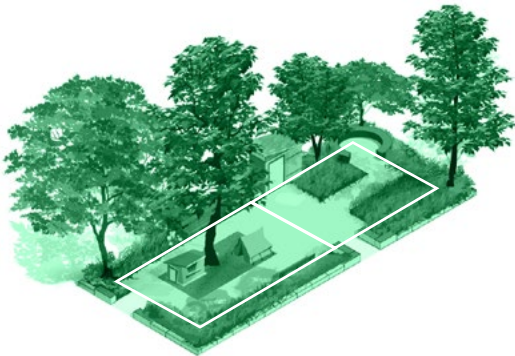

NATURE THEME

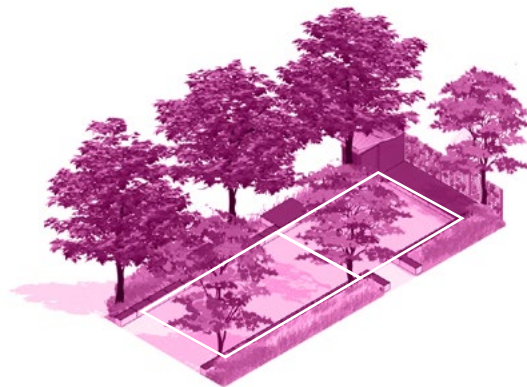

EVENT THEME

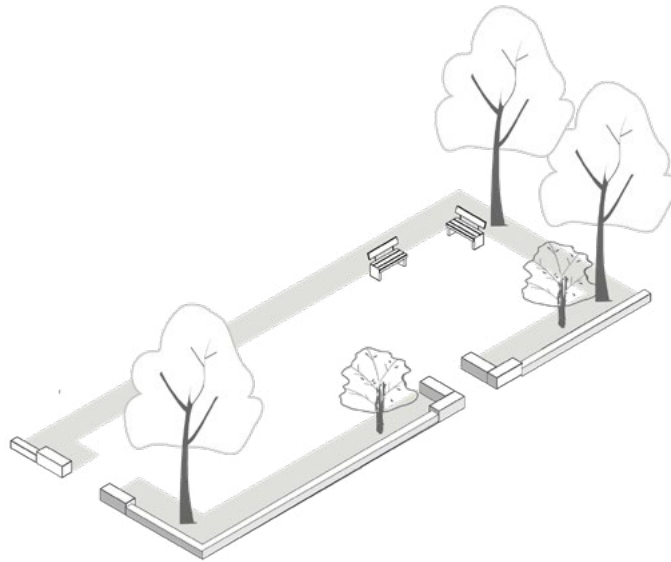

BASE DESIGN

The base design illustrated below utilizes a few key elements common to all four park themes. They include...

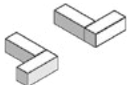

GABION WALL

Gabion (wire) basket walls are filled with stone and give the park a distinct edge. They can be filled with found objects such as brick and broken up concrete for more sustainable and lower cost construction.



BENCH

A place for sitting easily customized by your community! The benches can be painted or allowed to weather—either works! While we give you ideas on placing benches in your park, you can use them in all sorts of configurations.



RAIN BARREL

All parks need water! There are a number of methods for collecting rain water. Add rain barrels for stormwater management and watering trees and flowers.



PLANTS

All parks have native plants that attract wildlife, increase biodiversity and promote conservation.

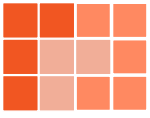

EDIBLE THEME

This is a community space for sharing food and connecting with neighbors and guests—including pollinators (bees, birds, butterflies and bats) who are essential for growing edible plants and food! Distinct features of this theme include shared fruit and vegetable gardens, a place to prepare neighborhood meals and a recipe board. The physical elements of this park are listed and shown on the next page and notated in the park pieces you will print out.

3D VIEW

ILLUSTRATION OF THE PARK



PLAN VIEW

ILLUSTRATION OF THE PARK

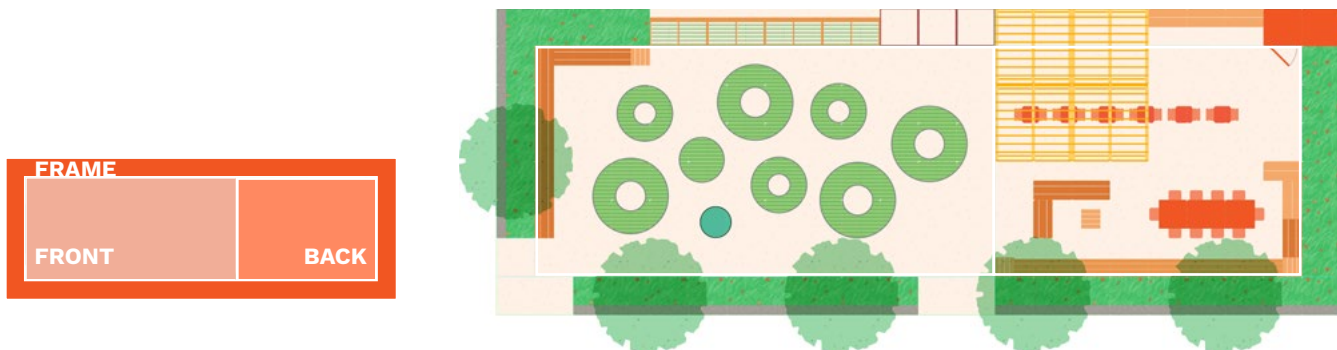

EDIBLE THEME ELEMENTS



COMMUNAL TABLE

Community table for communal dining



EDIBLE VEGETATION

Fruit trees, shrubs, flowers and veggies to feed wildlife and humans



COLD FRAMES

Cold frames, planted with veggies, can extend your growing season

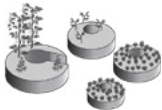

RAISED BEDS

Keyhole-style self-composting vegetable bed or planters

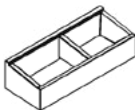

COMPOST BINS



WORKBENCH/STANDING TABLE

Workbench/Standing table for food or garden prep



SHED

OPTIONAL ELEMENTS



SHADE CANOPY

Canopy for shade and enclosure



TABLES + CHAIRS

Movable tables and chairs



SANCTUARY THEME

Music in the park, a spring art fair, a monthly flea market, a Halloween haunted house. This theme is perfect for hosting all kinds of neighborhood events throughout the year. Distinct features include an open 'floor plan' for flexible set up for different events, and a small platform for performances, and gallery spaces to display artwork or school projects. The physical elements of this park are listed and shown on the next page and notated in the park pieces you will print out.

3D VIEW

ILLUSTRATION OF THE PARK

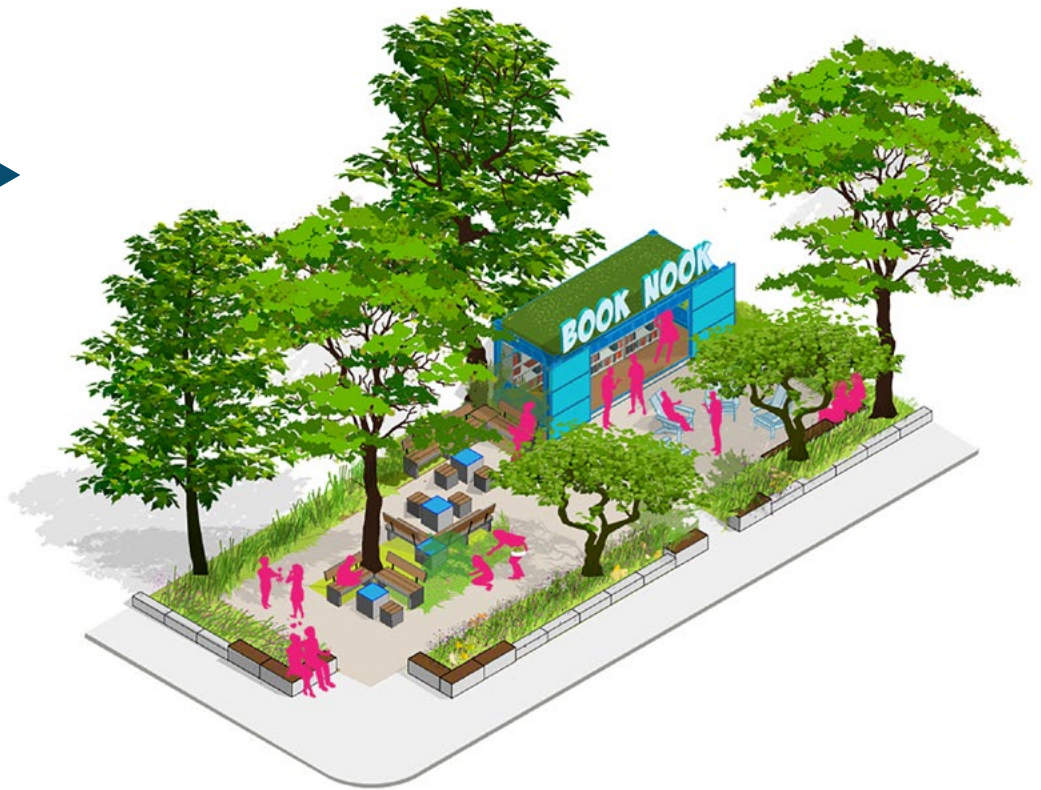
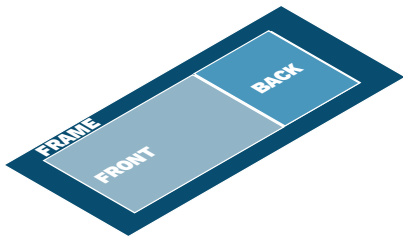

PLAN VIEW

ILLUSTRATION OF THE PARK

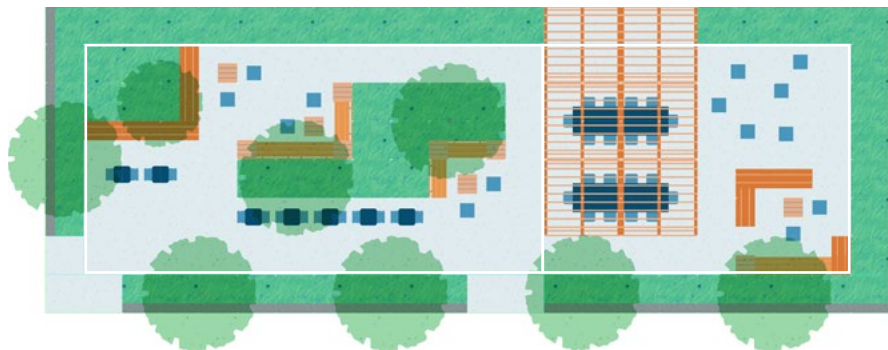
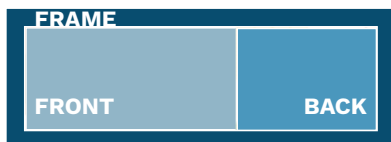

SANCTUARY THEME ELEMENTS

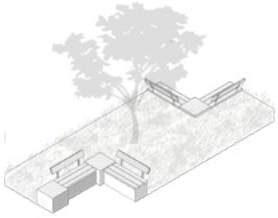

PLANTING + SEATING

A planting island with a tree, surrounded by seating



EDIBLE VEGETATION

Fruit trees, shrubs, flowers and veggies to feed wildlife and humans



TABLE + STOOLS

Customize these tables + Chairs, paint a chess board on the table, or arrange a few for a community dining table. They are modular!



SHADE STRUCTURE

To shade the park, and create a 'room' for events like story hour, poetry readings or bible studies.



COMMUNAL TABLE

Community table for events or gathering



WOOD TOPED GABIONS

Double-sided benches, also used as edging for planting.

OPTIONAL ELEMENTS



FREE-STANDING HAMMOCK

Hammocks can be enjoyed by all, and can be moved around!



PORCH SWING

Freestanding porch swing



SOLAR FOUNTAIN

Provides water for wildlife and calming sounds for humans

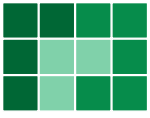

NATURE THEME

A calming refuge of solitude in the city, and a great place for smaller gatherings, outdoor workshops and classrooms. With the community circle area you can toast marshmallows or have a study group. Nature-based play is important with this theme, so many of the park elements are natural like stumps, logs, rocks or an oversized play 'nest.' The physical elements of this park are listed and shown on the next page and notated in the park pieces you will print out.

3D VIEW

ILLUSTRATION OF THE PARK

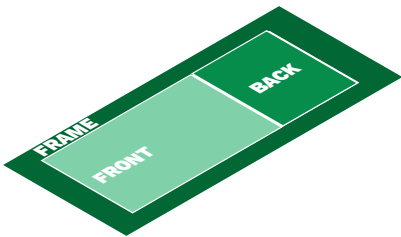

PLAN VIEW

ILLUSTRATION OF THE PARK

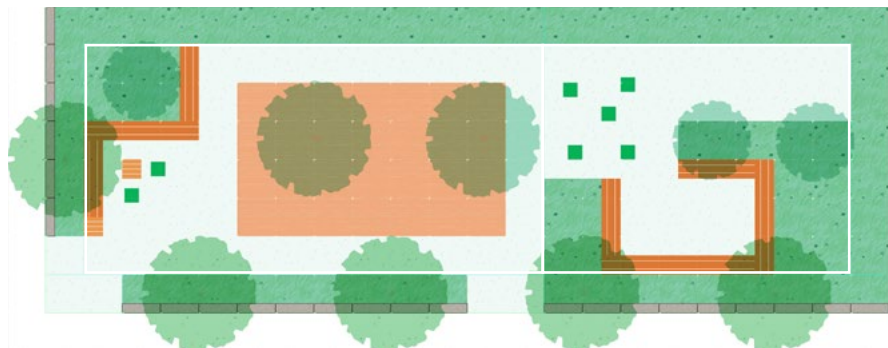
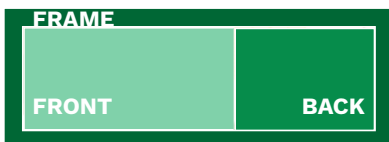

NATURE THEME ELEMENTS



OUTDOOR CLASSROOM

Gathering area for classroom or community seating for events

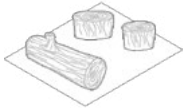

NATURE PLAY

Area for young or old kids with a log or two and a few stumps to



TABLE + STOOLS

Customize these tables + Chairs, paint a chess board on the table, or arrange a few for a community dining table. They are modular!



WOOD TOPPED GABIONS

Double-sided benches, also used as edging for planting

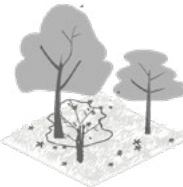

HABITAT

Native habitat for pollinators (bees, birds, butterflies and bats)

OPTIONAL ELEMENTS



BIRDBATH

Water for pollinators or solar water fountain

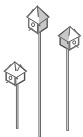

BIRD ACCESSORIES

Nesting boxes, houses and feeders for pollinators



SHADE CANOPY

Overhead trellis canopy for shade and enclosure



TABLES + CHAIRS

Comfortable sitting area to enjoy a coffee or tea and soak in the



EVENT THEME

This is the most versatile of the park themes as it can accommodate a wide range of park use. This theme emphasizes small spaces to relax and read a book, take a class, play board games or talk with a neighbor. Distinct features include cozy seating, calming sound of water, small event area for classes or individual meetings. The physical elements of this park are listed and shown on the next page and notated in the park pieces you will print out.

AXONOMETRIC VIEW

ILLUSTRATION OF THE PARK

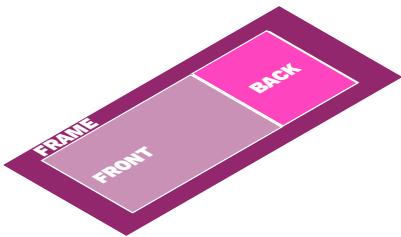

PLAN VIEW

ILLUSTRATION OF THE PARK

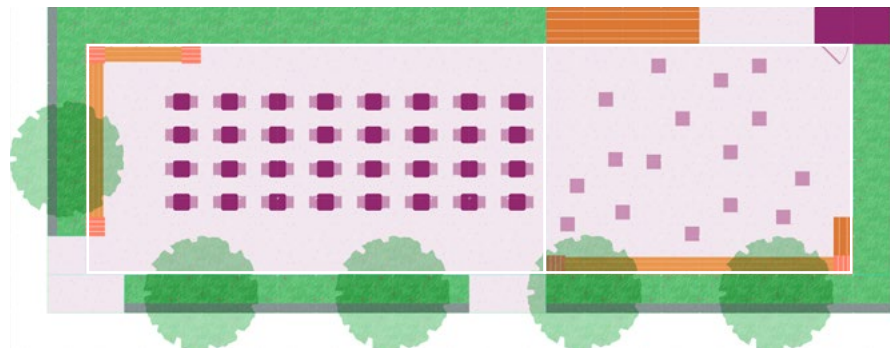
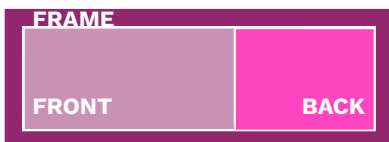

EVENT THEME ELEMENTS

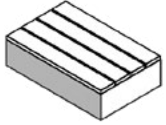

STAGE

Gathering area for classroom or community seating for events



SHED

For storing flexible furnishings and other event furnishings.



TABLE + STOOLS

Customize these tables + Chairs, paint a chess board on the table, or arrange a few for a community dining table. They are modular!



WOOD TOPPED GABIONS

Double-sided benches, also used as edging for planting.

OPTIONAL ELEMENTS

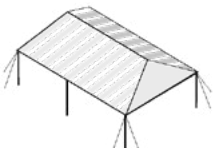

EVENT TENT

Tent for temporary events, stored in the shed



FLEXIBLE SEATING

Adirondack chairs or other flexible seating



SHADE CANOPY

Overhead trellis canopy for shade and enclosure



TABLES + CHAIRS

Flexible furnishings for eating



THEMED DESIGN

Evaluate the four different park themes on the previous pages and identify which is closest to meeting your neighborhood's goals and desired uses for the new park.

Are there particular reasons why you prefer one park theme more than the others?

Are there specific park qualities in the park themes that are most desirable to you?

What is your preferred park theme?

Go to your Summary Page from the Assess Workbook where you listed the number of trees, amount of sun, and the lot location.

EDIBLE THEME

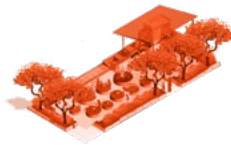

- ✓ FEW OR NO TREES
- ✓ FULL SUN OR MOSTLY SUN
- ✓ WELL SUITED FOR CORNER LOT

SANCTUARY THEME



- ✓ ANY AMOUNT OF TREES
- ✓ ANY AMOUNT OF SUN
- ✓ MID-BLOCK OR CORNER LOT

NATURE THEME



- ✓ FEW OR SEVERAL TREES
- ✓ ANY AMOUNT OF SUN
- ✓ MID-BLOCK OR CORNER LOT

EVENT THEME

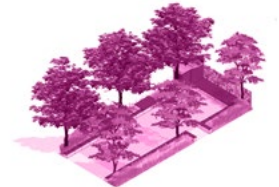

- ✓ FEW OR SEVERAL TREES
- ✓ ANY AMOUNT OF SUN
- ✓ WELL SUITED FOR CORNER LOT

Do the themes you choose work with the site characteristics on your summary sheet?

YES !

NO
(Re-evaluate park theme)



DOWNLOAD THE PARK PIECES

After reviewing the park themes to develop your park design, you should have an idea of what puzzle pieces you would like to play with. But first you need to find the right size and shape frame for your existing lot size and placement. In your Assess Summary page, you noted the size of the park, and there was a letter associated with that size. You also noted if you had a corner lot or a mid-block lot.

Click on the download icon  by your lot location and size on the next page to begin the download of your park pieces.

LOT LOCATION?

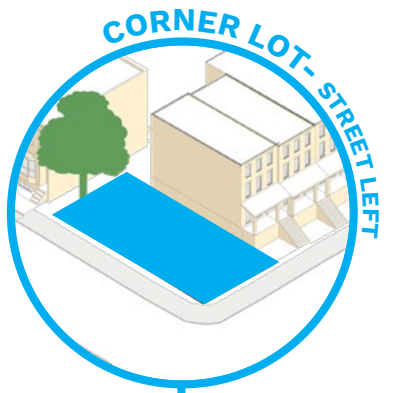
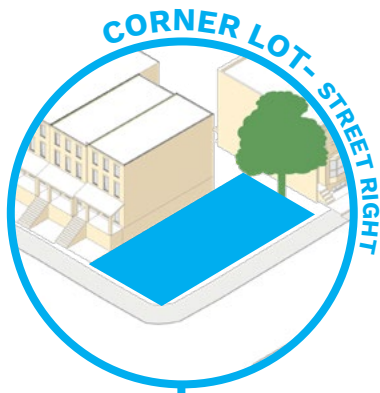

LOT SIZE ?

L
W



L
W



L
W



L
W



L
W





PRINT + CUT THE PIECES

Open the themed park pieces you just downloaded and print them out on single-sided 8.5" x 11" paper. Then cut the pieces out along the dashed line, like the enlarged one shown below.

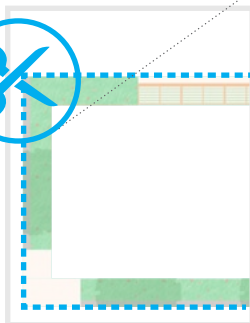
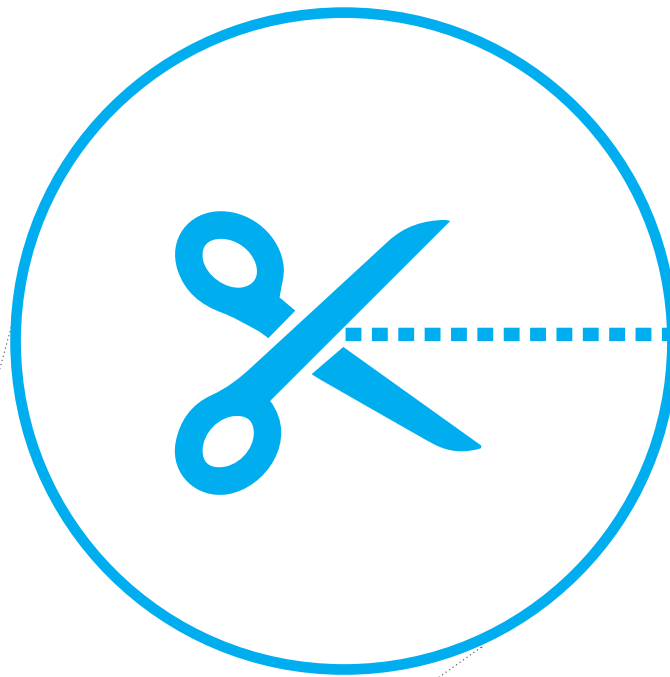

SHEET 1

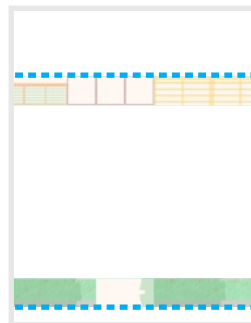

SHEET 2

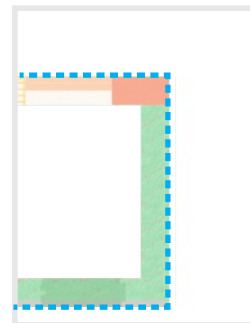

SHEET 3



ALIGN THE SYMBOLS + TAPE

Now you have a bunch of pieces of cut paper. Align them with the align symbols, and tape them together. 

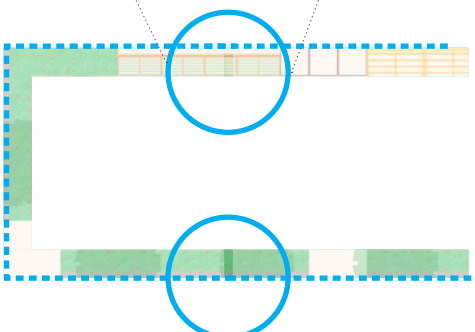
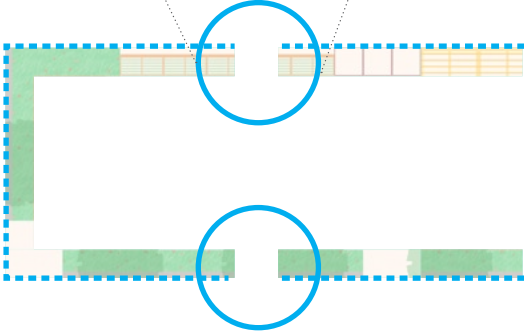
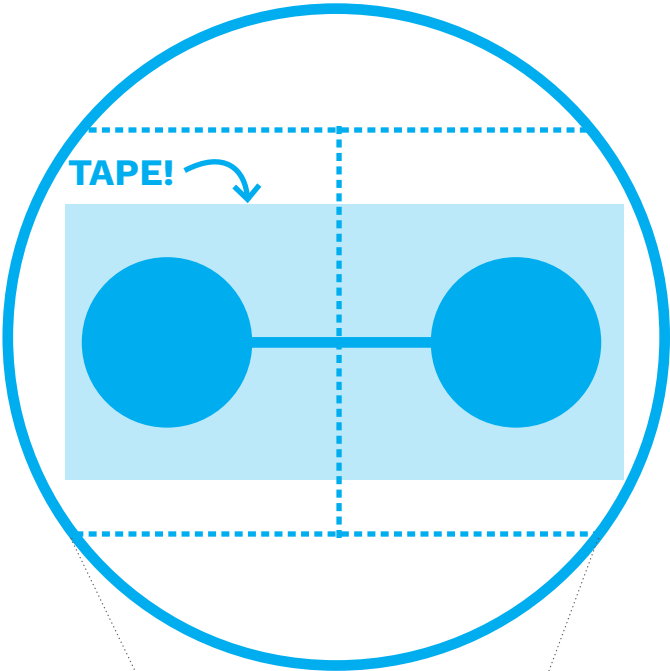
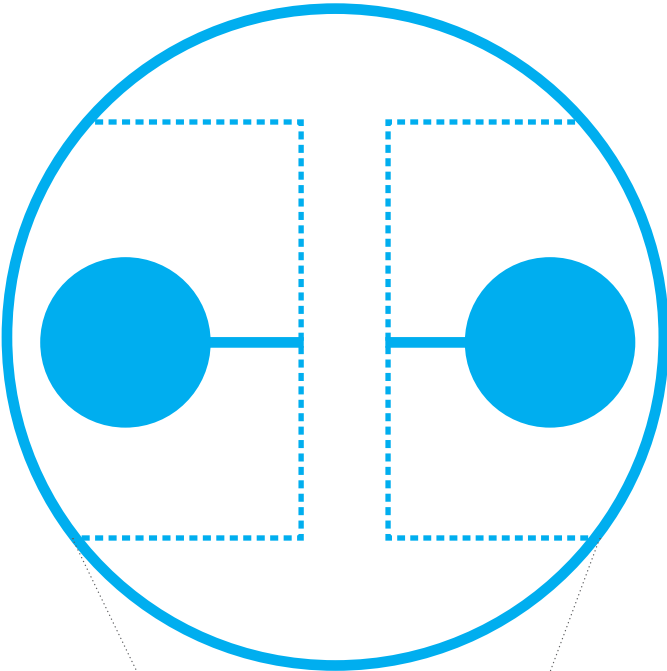



PLAY WITH THE PIECES

USE ALL ONE THEME...

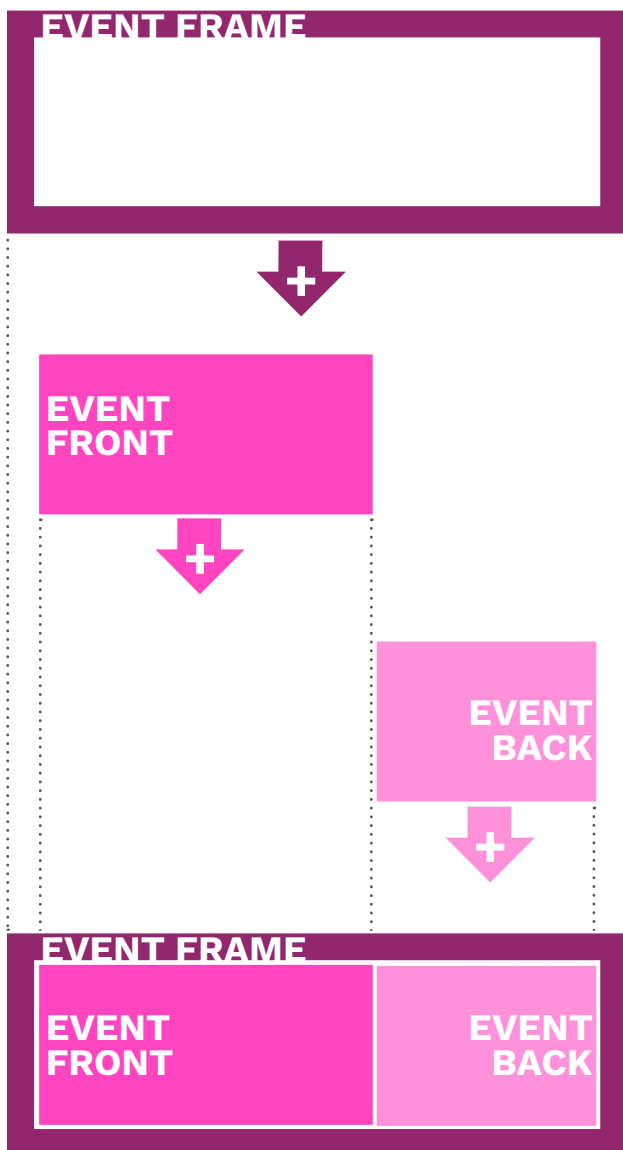

OR MIX AND MATCH!

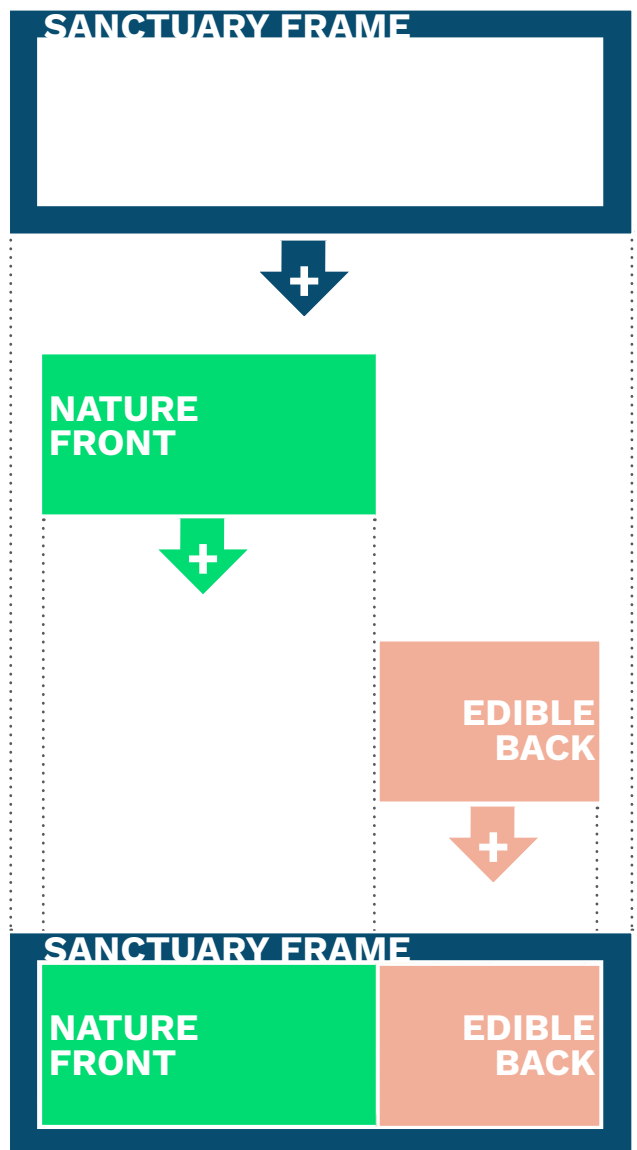

...ENDLESS COMBINATIONS!

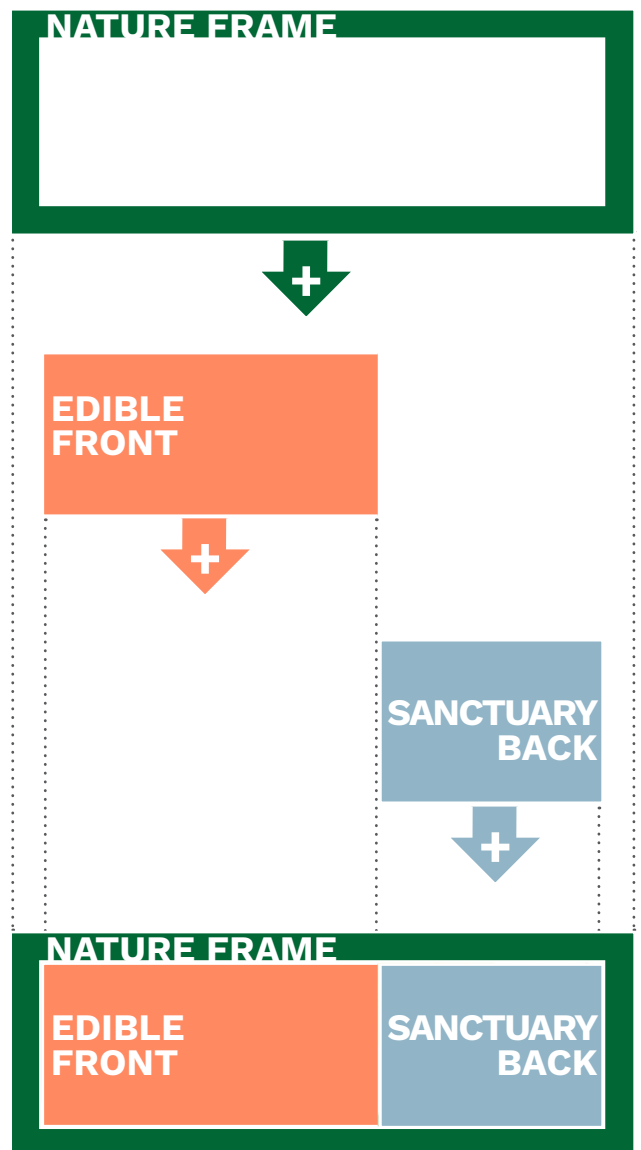
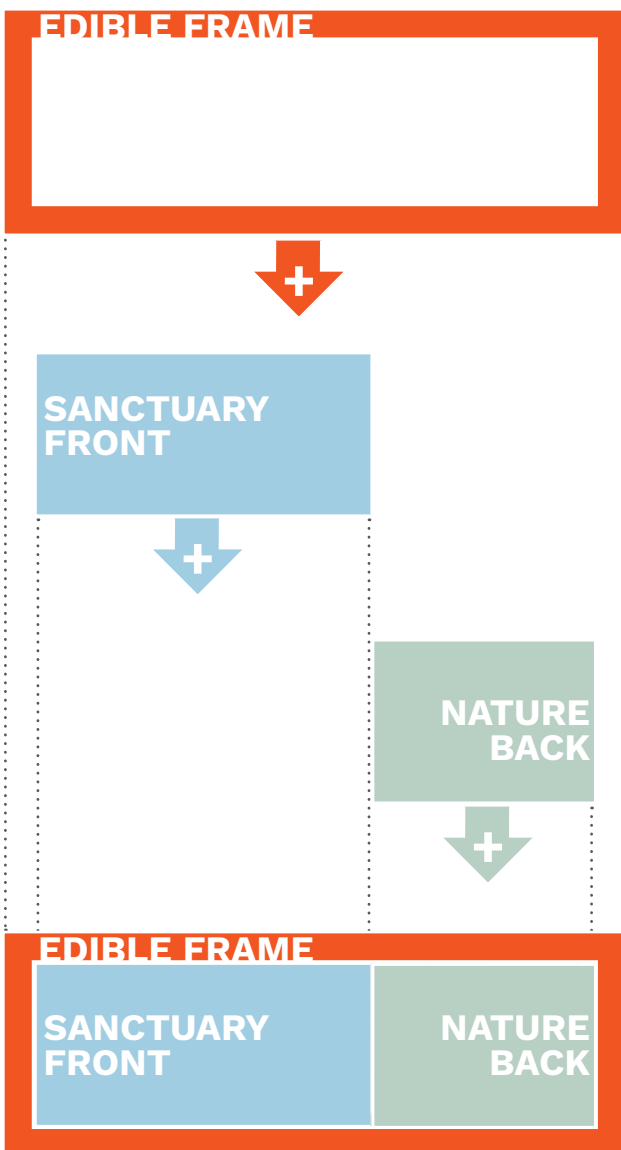



RIGHT SIZE YOUR PARK

If your lot perfectly fits your pieces, please go to the next step, 'Add your existing conditions'. If there's extra room, then you can expand your park by adding more features! This step will ensure you use all the available space to make the perfect park.



Here we will show an example of how to expand your park. For this demonstration, we will use a corner lot, size D.

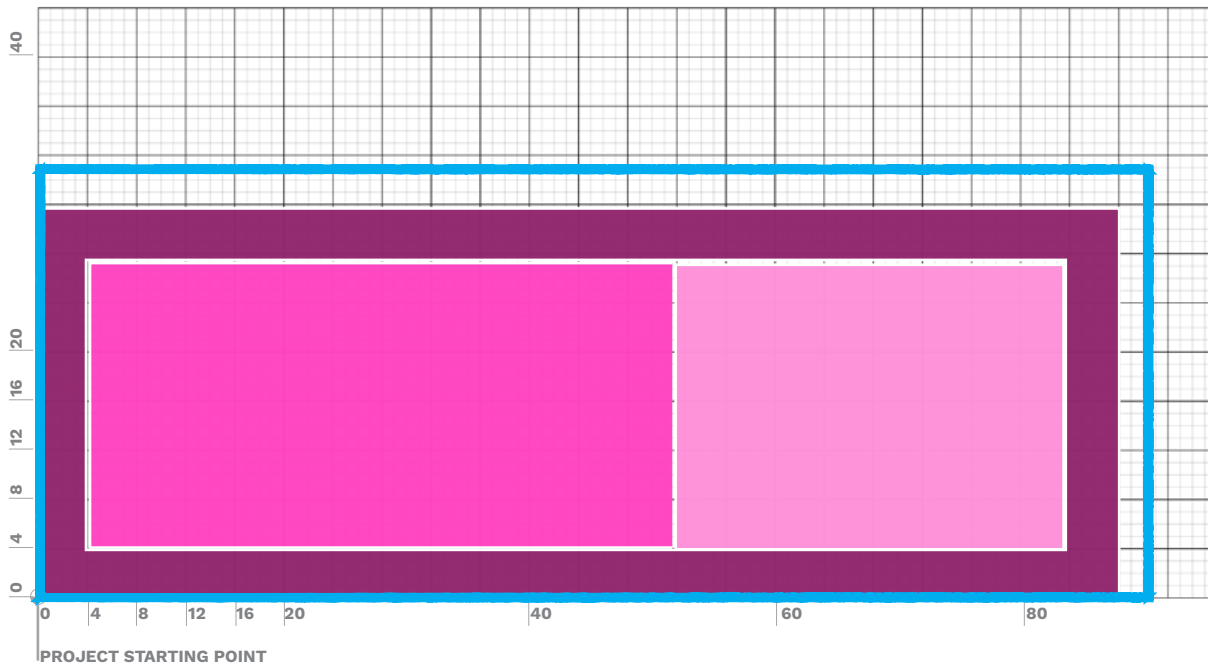

The size of the puzzle pieces make an 88' by 32' lot. However, in 'Assess,' the example lot was 35' by 90'. This means the lot size is 3 feet wider and 2 feet longer than our lot. To expand our park, we will need to start with the seams.

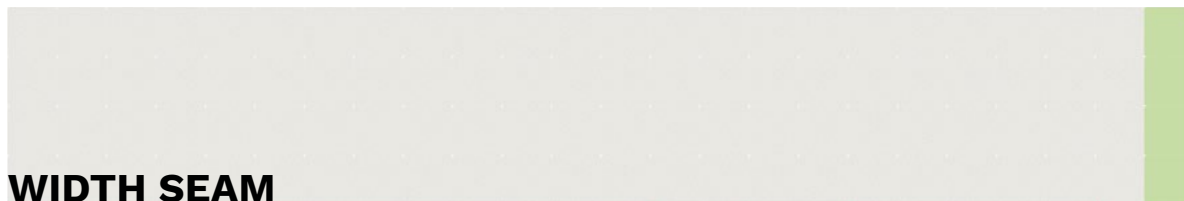

LENGTH SEAM

Begin with your length seam. In our example, our lot was 2 feet longer than the park pieces. We add this extra 2 feet by cutting the seam between the park front and back. There are black dashed lines on your seam to indicate every 4 feet, and grey dashed ones to indicate 1 foot.

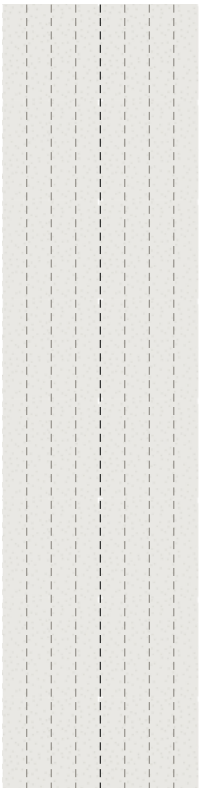

SEAM

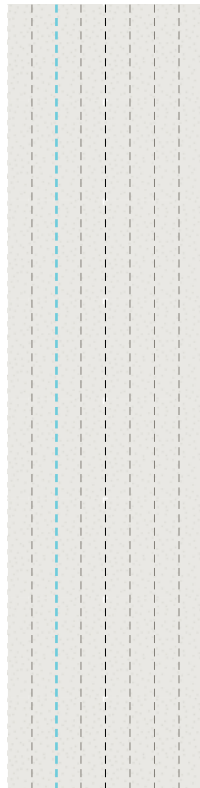

COUNT

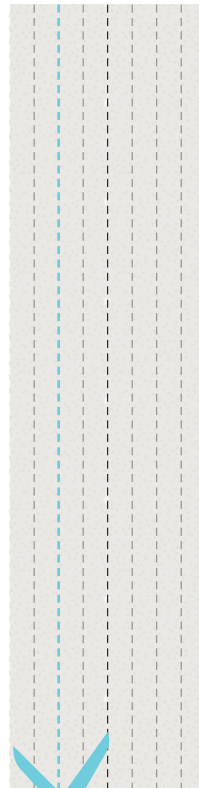

CUT



DONE!

ADD YOUR LENGTH SEAM

Cut your taped-together park along the middle seam.

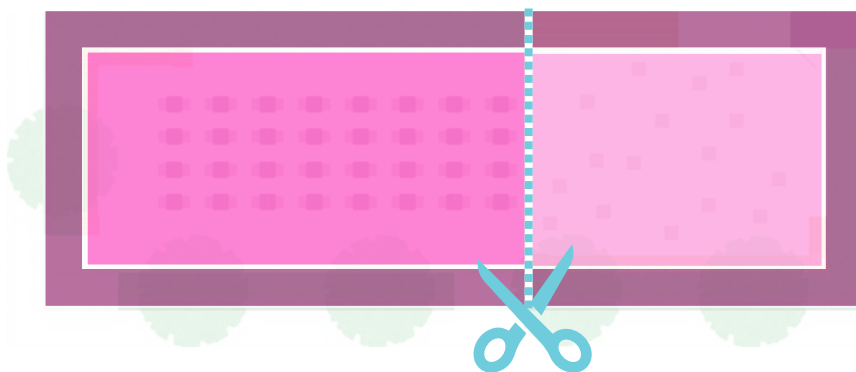

CUT!

Add this width seam in the middle between the two ends of the park, and tape it together.

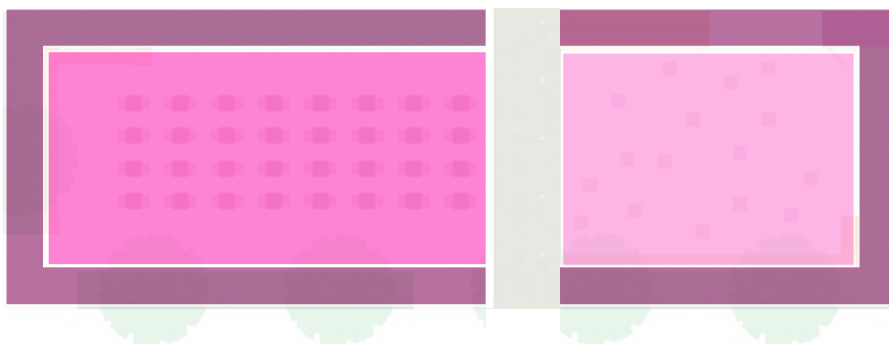

ADD!

WIDTH SEAM

Move to your width seam. In our example, our lot was 3 feet wider than the park pieces. So, we trim the seam to create the extra 3 feet we need. There are black lines on your seam to indicate every 4 feet, and grey dashed ones to indicate 1 foot. We will then cut this down to the length of the park we have, which is 90 feet.

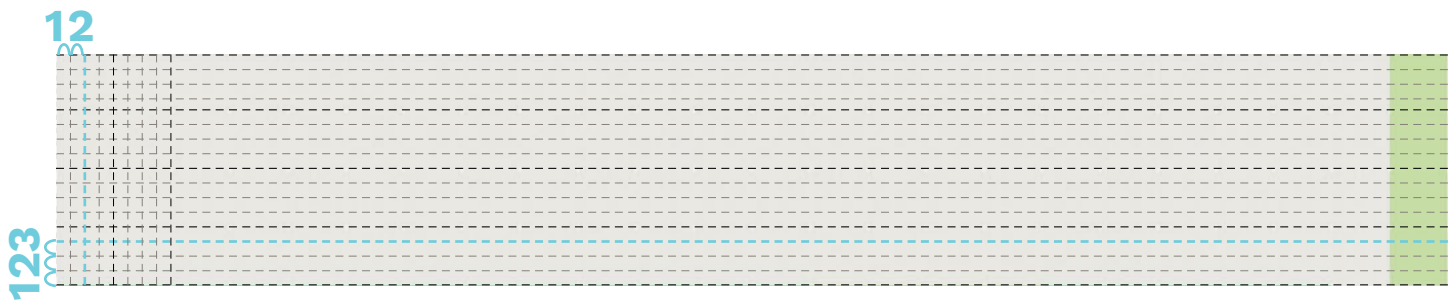

COUNT

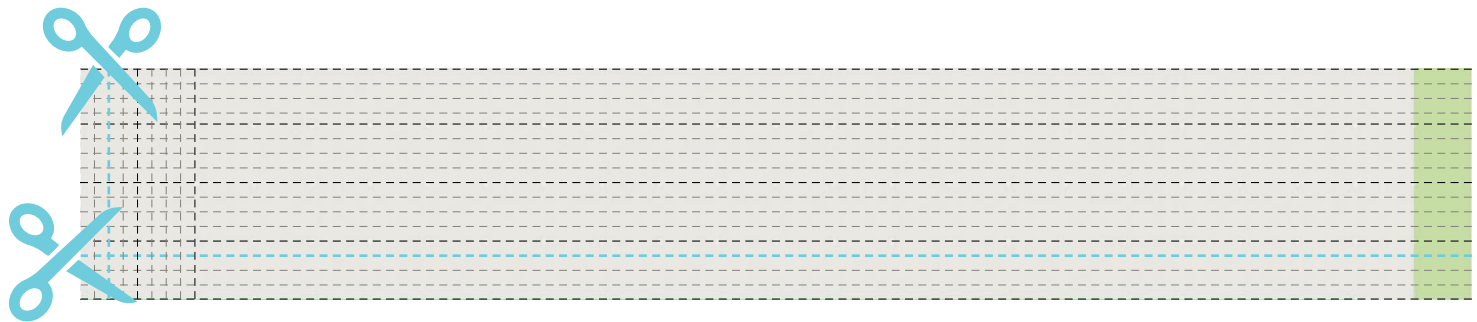

CUT



DONE!

ADD YOUR WIDTH SEAM

Cut your taped together park along the lengthwise seam.

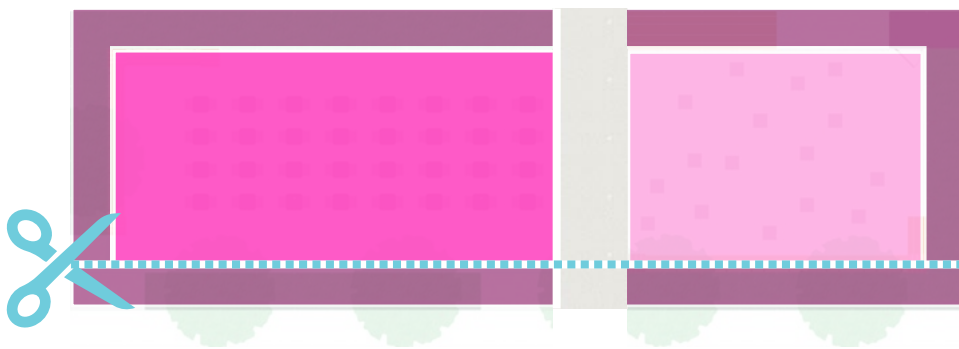

CUT!

Add your width seam in the middle between the two sides of the park and tape it together.

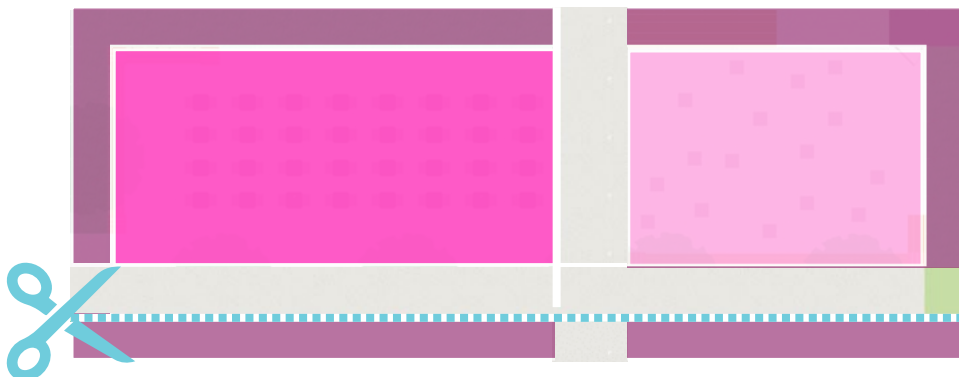

ADD!

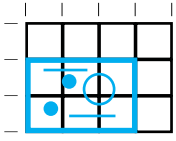

ADD YOUR EXISTING CONDITIONS

Now you will transfer the existing conditions from the original site plan you drew in the Assess Workbook to the design plan you just created. Simply place the two plans side by side and copy the existing feature onto the design plan. The grids are the same, so just count the boxes to find the location of the items and draw them in.

If an existing tree lands in planting, that's great! If it lands in gravel, that is okay too. There are instructions on how to deal with this in the 'Create Workbook.' If you run into a situation where your existing conditions clash with your design, like there is a tree on top of a bench, you can remove the bench by crossing it out. You can also move the bench by shifting the whole front or back piece. The design you have is a template and although it is somewhat rigid that doesn't mean you can't add or remove things to make it work for you!

1 BOX IS 4 UNITS (FEET)

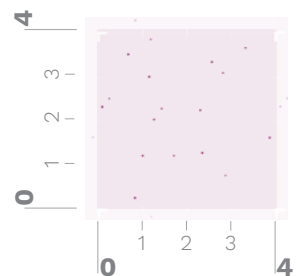

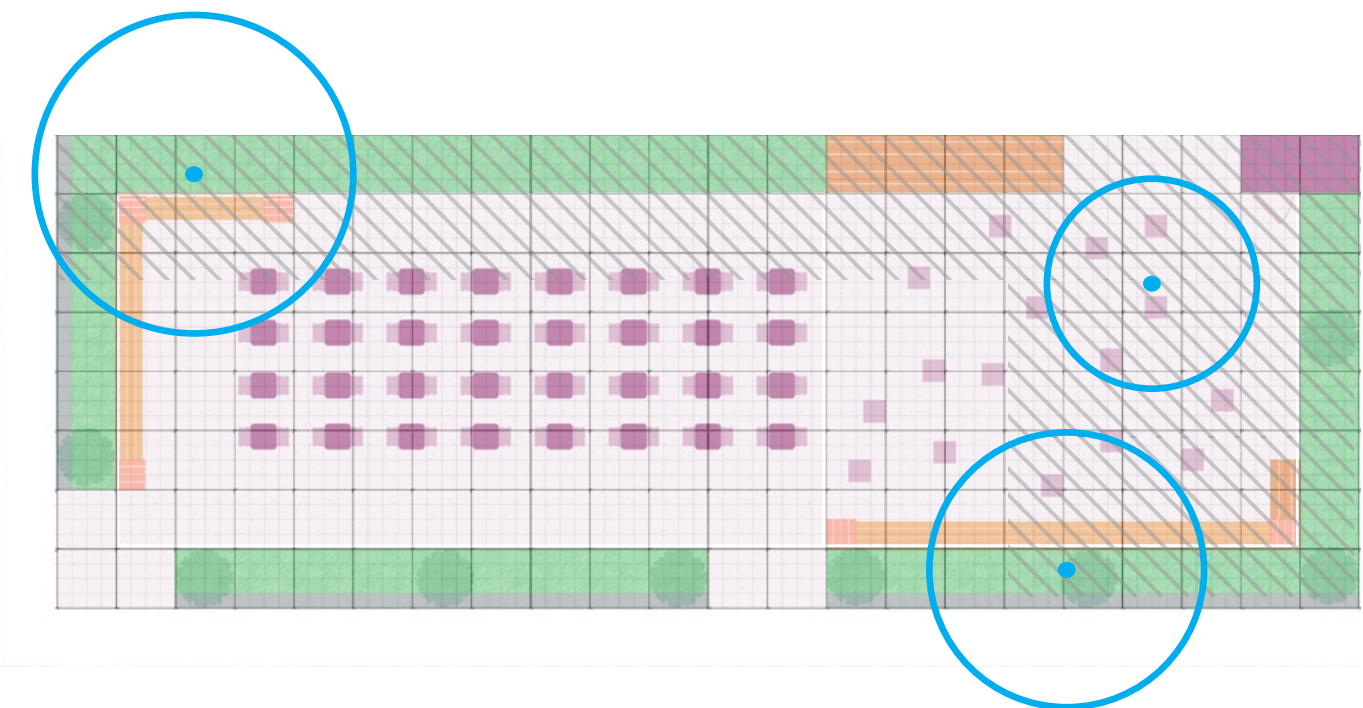
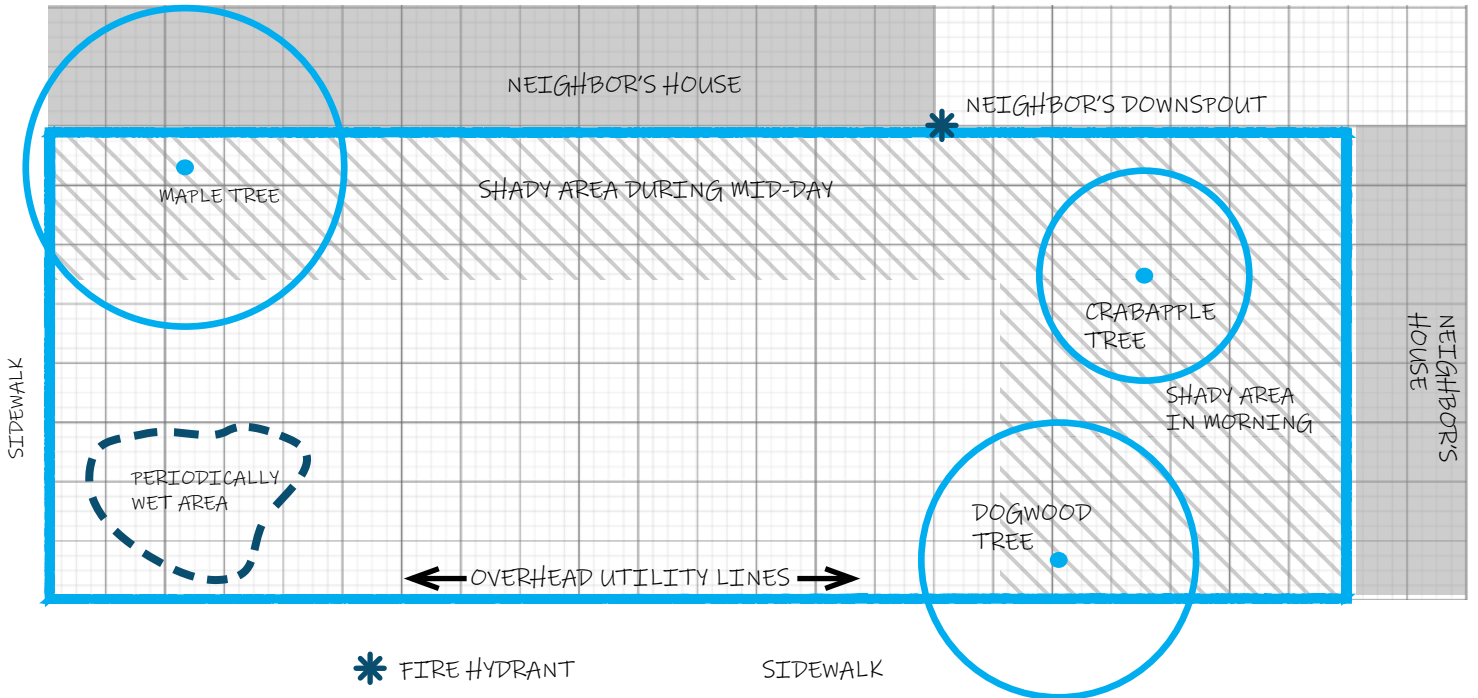

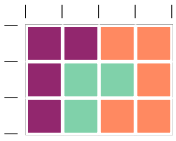

COUNT YOUR PIECES

It is now time to tally your site plan! In your park pieces, each front, back and frame have a tally of all your items so you can calculate the cost, as well as order materials! Use the spreadsheet in the link below to fill in the orange squares. It will ask you questions like:

LENGTH

How many feet is the LONG side of your lot? _____

WIDTH

How many feet is the SHORT side of your lot? _____

PLANTING

How many green squares do you have? _____

FURNISHINGS

Use the key in your park pieces package, count your furnishings and enter the totals into this spreadsheet (you will enter all totals from all count pages into this spreadsheet).

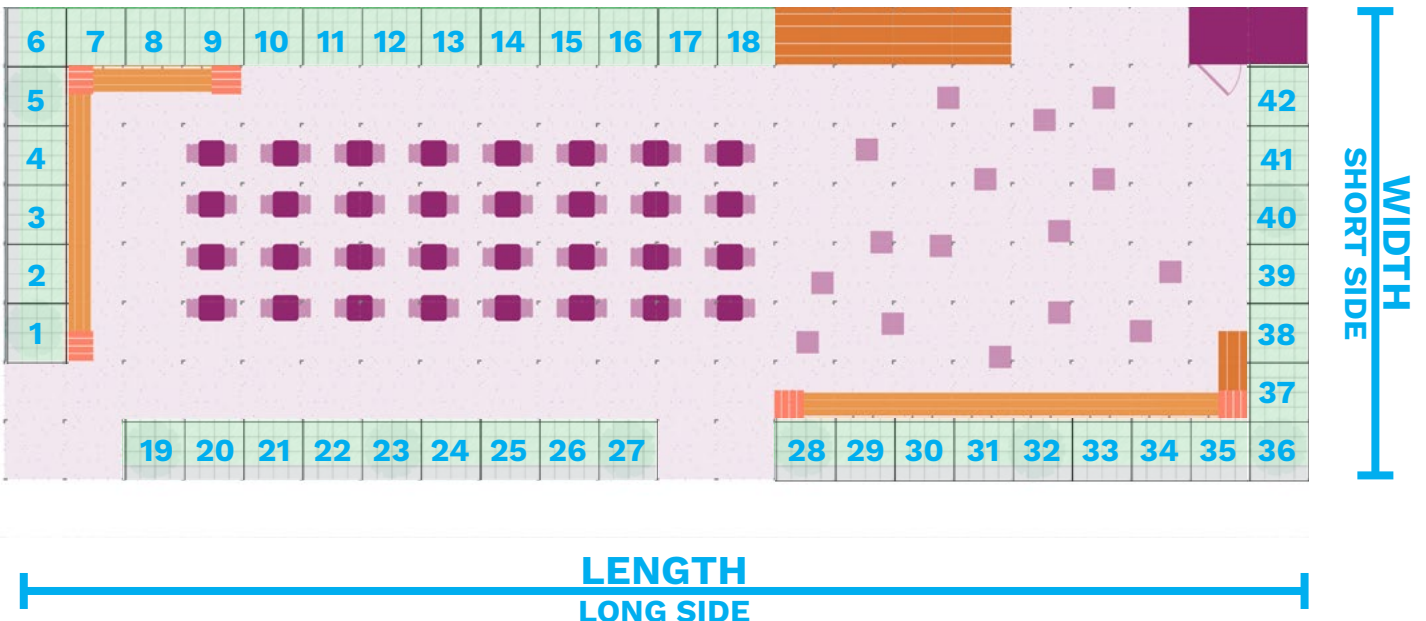

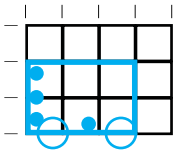

COUNT YOUR PLANTS

Everywhere there is green, is your planting area! These planting areas contain symbols. Each one of these symbols has a plant size with it. You will now count up the number of perennials plant, shrubs, small trees and big trees you have in your design. You will determine the types of plants in another step.



PERENNIALS

How many green squares in sun? How

_____ _____
SUN SHADE



SHRUB

How many shrubs on your plan are in

_____ _____
SUN SHADE



SMALL TREE

How many small trees are on your plan?

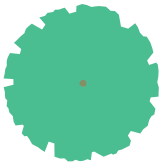

LARGE TREE

How many large trees are on your plan?

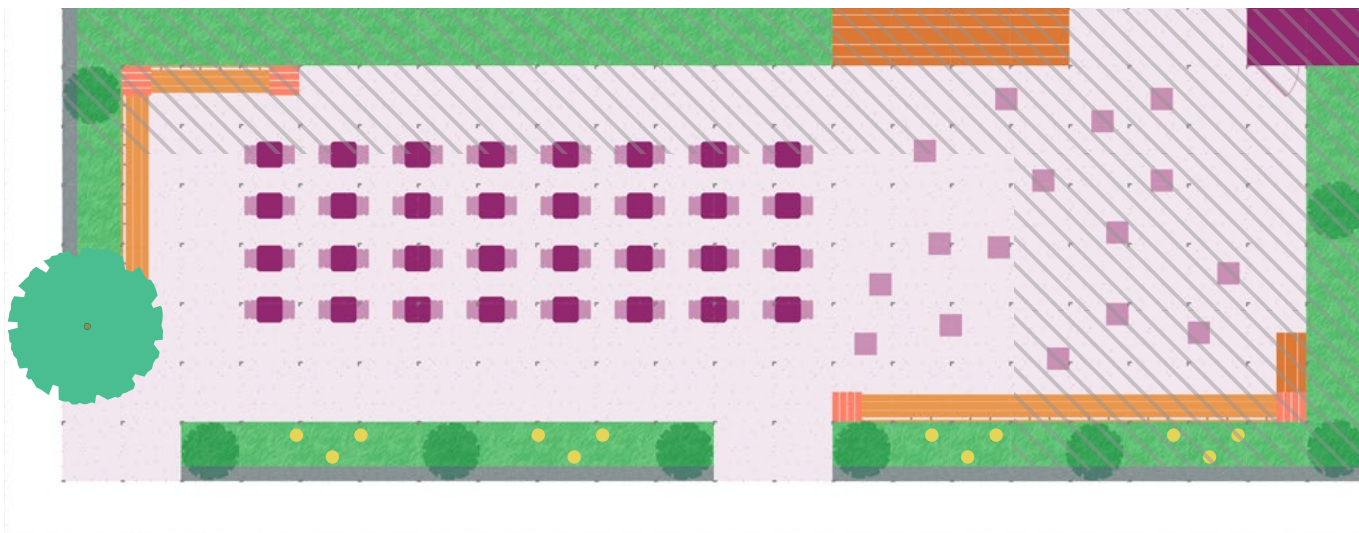

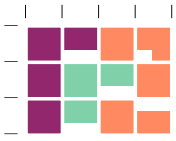

ASSEMBLE

Now it is time to see how the park elements are built. Some of the elements have custom instructions, or assemblies. These assemblies are a step-by-step guide to help you build your park elements. For example, say you have a bench in your park. That bench comes with an Ikea-like set of building instructions. Other park elements come with a design or a suggested way to build the element from pre-tested instructions. Lastly, others are simply off-the-shelf products. In the next few pages we have listed the items with custom instructions. Each item has a link to either an assembly, a website for instructions, or a website to buy the product. If you have one of these elements in your park, click on the link to figure out how to build it! You can also add these elements into your park, even if they aren't in your park. These assemblies are also found in the "Create Workbook."

PARK ELEMENTS

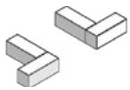

GABION WALL

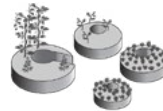

RAISED BEDS



BENCH

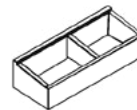

COMPOST BINS



RAIN BARREL



WORKBENCH/
STANDING TABLE



WOOD TOPPED GABION



SHED

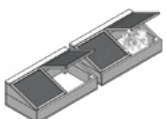

COLD FRAMES



SHADE CANOPY



TABLES + CHAIRS

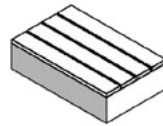

STAGE

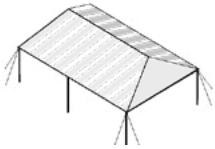

EVENT TENT



BIRDBATH



FLEXIBLE SEATING

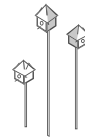

BIRD ACCESSORIES



OUTDOOR CLASSROOM



COMMUNAL TABLE

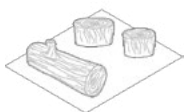

NATURE PLAY

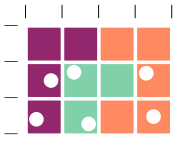

CHOOSE YOUR PLANTS

Each of the themed designs has its own ideal plant list. Click on the link below to download a spreadsheet with the plant list for that theme. Please make your own copy of this spreadsheet, so you can edit it!

The lists of plants are just suggestions. You can add your own plants if you like. The list is divided into shade and sun shrubs, shade and sun perennials, small trees and large trees. If you are mixing two themes for the park plan, then you should pick plants from both lists for purchase.



**EDIBLE
PLANT LIST**



**SANCTUARY
PLANT LIST**



**NATURE
PLANT LIST**



**EVENT
PLANT LIST**





ARE YOU READY?

Congratulations for completing the Dream Workbook. Below is a summary of what you have done. Please check off each step to ensure you have completed them before moving on to the 'Create Workbook'

THEME DESIGN REVIEW

You have reviewed the themes, and decided which themes best fit your needs

CUSTOM DESIGN

You have printed out the park puzzle pieces and played with them to choose a final park design

CUSTOM SIZE

You have 'right sized' your park to fit dimensions and existing features of your lot

COST ESTIMATE

You have entered in your custom design by counting your pieces and have put them into the cost-estimate spreadsheet

PLANT CHOICE

You have chosen plants based off the number of plants you have